

Recommended P.C.Board Layout(Top View)  
(PCB Board Tolerance±0.05)

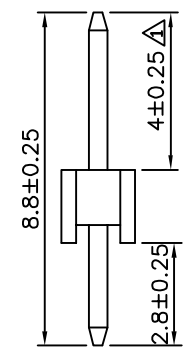
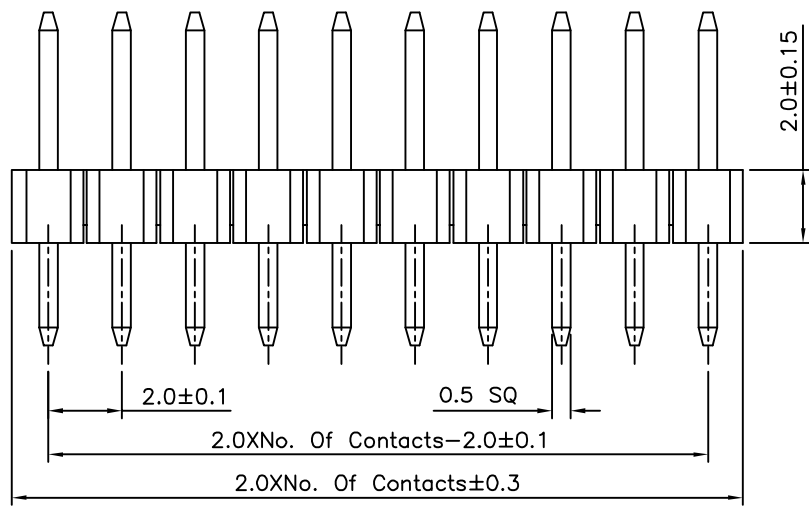
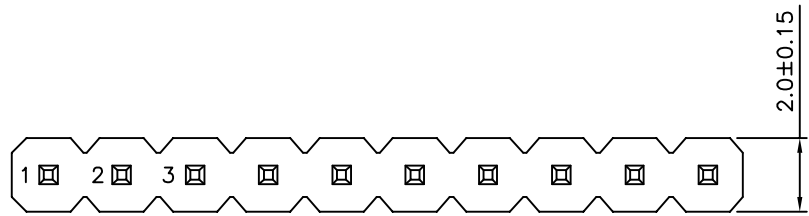

**SPECIFICATION**  
 Current Rating:1.5 Amps  
 Withstand Voltage:500V AC  
 Contact Resistance:20 Milliohms Max.  
 Insulation Resistance:1000 Megaohms Min.  
 Operation Temperature Range:-40°C~+105°C  
 Insulator:PA6T(UL94V-0),Black  
 Contact:Brass,Gold Flash Over Nickel  
 RoHS Compliant

△ M D 1 X XX - H H  
 (1) (2) (3) (4) (5) (6)

- (1) M:2.0mm Pin Header
- (2) D:DIP Straight
- (3) 1:Single Row
- (4) XX:No. Of Position/Per Row
- (5) H:Withstand High Temperature Soldering
- (6) H:RoHS Compliant

**AUK** A MEMBER OF AUK GROUP  
**太聯事業股份有限公司**  
**AUK CONTRACTORS CO., LTD.**

CATEGORY		APPROVED BY EMILY	
PART No. MD1XXX-HH		CHECKED BY HZF	
DRAWING No. MD1XXX-HH		DRAWING BY YBL	
SCALE	NONE	REV.	A1

UNLESS OTHERWISE SPECIFIED TOLERANCES ARE △			
X	±0.25	X.*	±2°
.X	±0.20	.X*	±1.5°
.XX	±0.15	.XX*	±1°
.XXX	±0.10	.XXX*	±0.5°
UNIT	mm		
NO.	REV.	REVISIONS	CHK DATE
△ A1		Modify Data	HZF 01/07/2014
△ A0		NEW RELEASE	HZF 01/21/2011